



# NS120 Video Capture Wand

## Quick Guide

© 2021 Narvitech Corp.

English | 繁體中文

## Package Contents

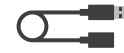

USB 3.0 Extension Cable



USB 3.0 Type A to Type C



Warranty Card



Quick Guide



XSplit Key



Cyberlink Key

## Parts and Ports

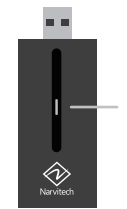

1	LED Light
2	USB 3.0 Male
3	HDMI In Port

## How to play Nintendo Switch/PS5/XBOX games on PC/laptop?

- 1** First, connect Video Capture Wand(also called NS120) to a console device via HDMI.

\*Switch has to be connected to the Dock.

- 2** Then, Connect NS120 to a PC/ Laptop

\*Please connect NJ300 to a USB3.0 port for higher resolution and low latency performance. Check the LED indicator on NJ300 to make sure it is connected to a USB 3.0 port.

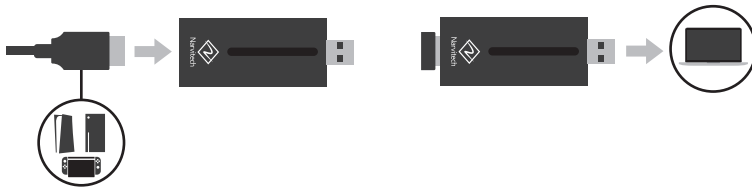

- 3** After setting up, open software (OBS, Screen Recorder 4, etc) and start playing immediately!

\*Please visit the official website for more NS120 and software setup instruction Narvitech Official website > Support > Download > NS120



### LED Indicator status

Blue	Connect to USB 3.0 port
Blue flashing	Live Streaming or Recording (USB 3.0)
Purple	Connect to USB 2.0 port
Purple flashing	Live Streaming or Recording (USB 2.0)
Red	No Video
Red flashing	No Support

## How to use NS120 for live streaming?

- 1** First, connect Video Capture Wand(also called NS120) to a video source(Console game, smartphone, etc.) via HDMI.

\*Switch has to be connected to the Dock.

- 2** Then, connect NS120 to a PC/Laptop.

\*Please connect NJ300 to a USB3.0 port for higher resolution and low latency performance. Check the LED indicator on NJ300 to make sure it is connected to a USB 3.0 port.

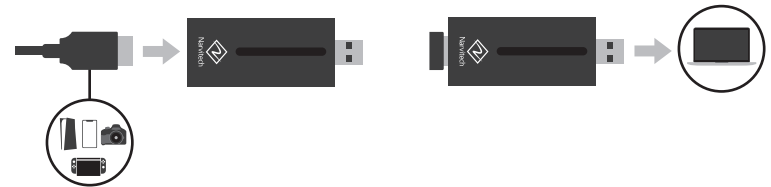

- 3** After setting up, open record/live streaming software (Xsplit, OBS, Screen Recorder 4, etc) and start playing immediately!

\*Please visit the official website for more NS120 and record/live streaming software instruction Narvitech Official website > Support > Download > NS120



### LED Indicator status

Blue	Connect to USB 3.0 port
Blue flashing	Live Streaming or Recording (USB 3.0)
Purple	Connect to USB 2.0 port
Purple flashing	Live Streaming or Recording (USB 2.0)
Red	No Video
Red flashing	No Support

## 包裝內容



NS120



USB 3.0 延長線



USB 3.0 Type A 轉 Type C



產品保固卡



快速指南



XSplit 序號卡



Cyberlink 序號卡

## 外觀簡介



2



3

- |   |            |
|---|------------|
| 1 | LED 指示燈    |
| 2 | USB 3.0 接頭 |
| 3 | HDMI 輸入接口  |

5

## 如何在筆電/PC上遊玩 Switch, PS5 或 XBOX?

- 1 首先，透過 HDMI 連接影像擷取棒(以下簡稱 NS120)與遊戲機。
- 2 接著再將 NS120 連接 PC 或是筆電。

\*Switch 需插上 Dock 底座

\*PC/筆電端必須接上 USB 3.0 才有高畫質及低延遲的效果，是否接上 USB 3.0 接口可以參考 LED 指示燈

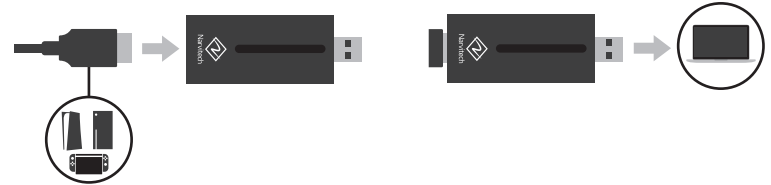

- 3 連接完畢後，打開軟體(如 OBS, Screen Recorder 4 等)就可以開始盡情暢玩囉!

\*NS120 與軟體的設定流程請至 Narvitech 官網 > 支援中心 > 下載專區 > NS120 的中找尋



### LED 指示燈狀態

藍燈	連接至 USB 3.0 接口
藍燈閃爍	直播或錄製中 (USB 3.0)
紫燈	連接至 USB 2.0 接口
紫燈閃爍	直播或錄製中 (USB 2.0)
紅燈	無影像訊號
紅燈閃爍	不支援此影像訊號

6

## 如何透過 NS120 進行直播或錄製?

- 1 首先，透過 HDMI 連接影像擷取棒(以下簡稱NS120)與視訊源(遊戲機、手機、相機等等)
- 2 接著再將 NS120 連接 PC 或是筆電。

\*Switch需插上Dock底座

\*PC/筆電端必須接上 USB 3.0 才有高畫質及低延遲的效果，是否接上 USB 3.0 接口可以參考 LED 指示燈

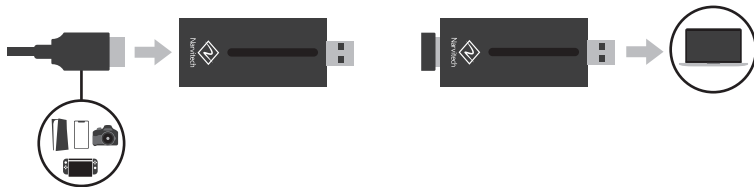

- 3 連接完畢後，打開直播軟體(如 XSplit, OBS, Screen Recorder 4 等)就可以開始直播或錄製囉!

\*NS120 與直播軟體的實況流程請至 Narvitech 官網 > 支援中心 > 下載專區 > NS120 的使用說明書中找尋



### LED 指示燈狀態

藍燈	連接至 USB 3.0 接口
藍燈閃爍	直播或錄製中 (USB 3.0)
紫燈	連接至 USB 2.0 接口
紫燈閃爍	直播或錄製中 (USB 2.0)
紅燈	無影像訊號
紅燈閃爍	不支援此影像訊號

7

Please visit [Narvitech.com](http://Narvitech.com) for more information | 更多 NS120 的資訊都在 [Narvitech.com](http://Narvitech.com)

Please go to "Contact us" on Narvitech Official website, our customer service are willing to help you for any further questions.  
NS120 user manual: [Narvitech official website > Support > Download > NS120](#)  
NS120 FAQ: [Narvitech official website > Support > FAQ > NS120](#)

如有使用上的問題，請利用官方網站的「聯絡我們」或 Facebook 粉絲團的私訊，我們將有專人為您服務。  
NS120 完整使用說明書: [Narvitech 官網 > 支援中心 > 下載專區 > NS120](#)  
NS120 相關 FAQ: [Narvitech 官網 > 支援中心 > FAQ > NS120](#)

### Copyright and Trademark | 版權及商標資訊

© 2021 Narvitech Corp. All Rights Reserved. Narvitech, NJ300, its products names and logos are trademarks or registered trademarks of Narvitech Corp. All other company and product names and logos may be trademarks or registered trademarks of their respective owners in certain countries. Product specifications are subject to change without notice.

©2021 Narvitech Corp. 保留所有權利。Narvitech 及其產品名稱和商標屬於 Narvitech Corp.，所有其他公司和產品名稱及商標可能是其各自所有者在某些國家的商標或註冊商標。

### ⚠ CAUTION | 注意

1. Do not scratch the product with sharp object to avoid peeling off the housing printing.
2. Do not bring the product close to fire source to avoid damage to the product.
3. Do not drop the product to avoid damage to the product.
4. Narvitech will not be responsible for the warranty if the product is damaged intentionally.
5. Please make sure to return color box, device, accessories all together within the warranty period, otherwise Narvitech will not responsible for the warranty.

1. 請勿使用銳利物體觸碰產品本體，以免造成外殼印刷剝落。
2. 請勿使用打火機接觸產品本體，以免造成硬體損毀。
3. 請勿重摔產品，以免造成硬體損毀。
4. 如惡意毀損產品，本公司恕不負保固維修責任。
5. 保固期內如需維修，請務必將外盒、產品本體、及所有配件一同寄回，否則恕不負保固責任。



82444-91640-00000-G 8